

# MOJACK™ ASSEMBLY INSTRUCTIONS FOR MJ-48, MJ-60 AND MJ-72

Hardware List = HL

Parts List = PL

## STEP 1

Place four 10mm x 65mm carriage bolts (HL #1), threads facing up, through four holes on base (PL A). Make sure the side of the base with spacers is facing down.

Place tower (PL B) on top of base by sliding holes through carriage bolts already inserted in base. The wheel mounts of the tower must face away from inside of the base.

Take four 10mm hex head nuts (HL #2) and securely tighten carriage bolts using a 17mm wrench.

## STEP 2

Place winch (PL C) on top of tower. Take 8mm x 25mm hex head bolt (HL #3), threads facing up, and secure front of winch to tower using 8mm washers (HL #4) and 8mm hex head nut (HL #5). Secure nut and bolt with 13mm and 14mm wrench.

On back right side of winch, take 8mm x 25mm hex head bolt (HL #3), threads facing down, and secure back of winch to tower using 8mm washers (HL #4) and 8mm hex head nut (HL #5). Secure nut and bolt with 13mm and 14mm wrench.

On left side of winch, take final 8mm x 25mm hex head bolt (HL #3), threads facing up, and secure back of the winch to tower using washer attached to safety chain (HL #6), 8mm washer (HL #4) and 8mm hex head nut (HL #5). Secure nut and bolt the 13mm and 14mm wrench.

## STEP 3

Attach winch handle by unscrewing bolt attached to winch and remove washer. Place winch handle on stem, place washer on stem and then secure bolt on stem with 18mm wrench.

## STEP 4

Take jack stand (PL D) and secure it to base by using 6mm x 85mm bolts (HL #7), 6mm washers (HL #8) and 6mm hex head nuts (HL #9). Make sure threaded end of bolt is towards the inside of base. Mitered corner of jack stand needs to face towards tower. Secure nut and bolt using two 10mm wrenches.

## STEP 5

Place jack stand inserts (PL E) into jack stand. The jack stand inserts are adjustable but must be secured with spring pin (HL #10).

## STEP 6

Secure T-Bar (PL F) to tower by placing T-Bar's vertical pieces around tower. Place rollers (HL #11) in between vertical pieces on T-Bar and secure them by using 10mm x 80mm shoulder bolts (HL #12), 10mm washers (HL #13), 8mm washer (HL #4) and 8mm hex head nuts (HL #5). Secure nut and shoulder bolt using 8mm hex key and 13mm wrench.

## STEP 7

Place quick link (HL # 14) through end of lifting strap attached to winch, lower winch by turning handle counter clockwise until quick link reaches T-Bar. Secure quick link to T-Bar by placing quick link opening through triangle loop of T-Bar and tighten quick link.

## STEP 8

Place wheel pads (PL G) into T-Bar and secure them using spring pin (HL #10). Face long end of wheel pad loop away from winch.

## STEP 9

Place wheels (PL H) onto axles attached to tower and secure using 2mm x 45mm cotter pins (HL #15).

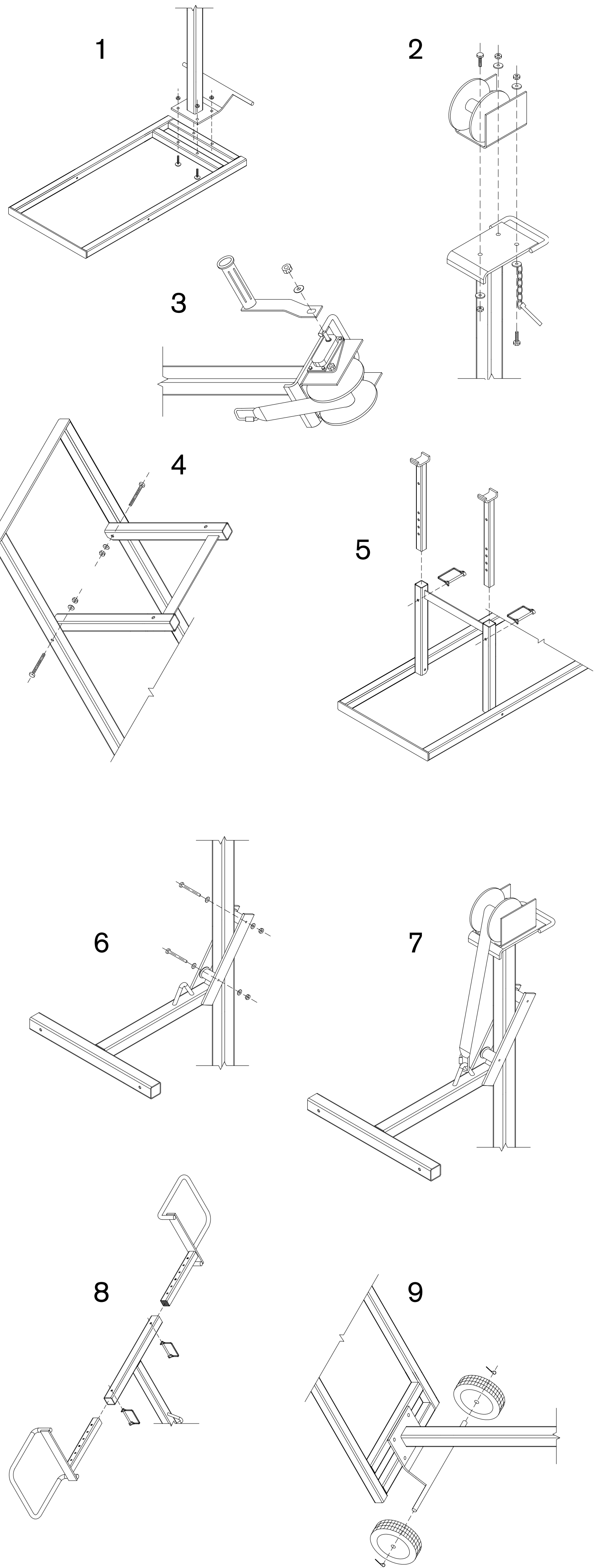

# HARDWARE

Item #	Quantity	Description	MJ-48	MJ-60 and MJ-72
1	4	10mm x 55mm carriage bolt	■	
1	4	10mm x 65mm carriage bolt		■
2	4	10mm hex head nut	■	■
3	3	8mm x 25mm hex head bolt	■	■
4	4	8mm washer	■	■
5	5	8mm hex head nut	■	■
6	1	safety chain	■	■
7	2	6mm x 75mm hex head bolt	■	
7	2	6mm x 85mm hex head bolt		■
8	2	6mm washer	■	■
9	2	6mm hex head nut	■	■
10	4	spring pin	■	■
11	2	rollers	■	■
12	2	10mm x 65mm shoulder bolt	■	
12	2	10mm x 80mm shoulder bolt		■
13	2	10mm washer	■	■
14	1	quick link	■	■
15	2	2mm x 45mm cotter pin	■	■

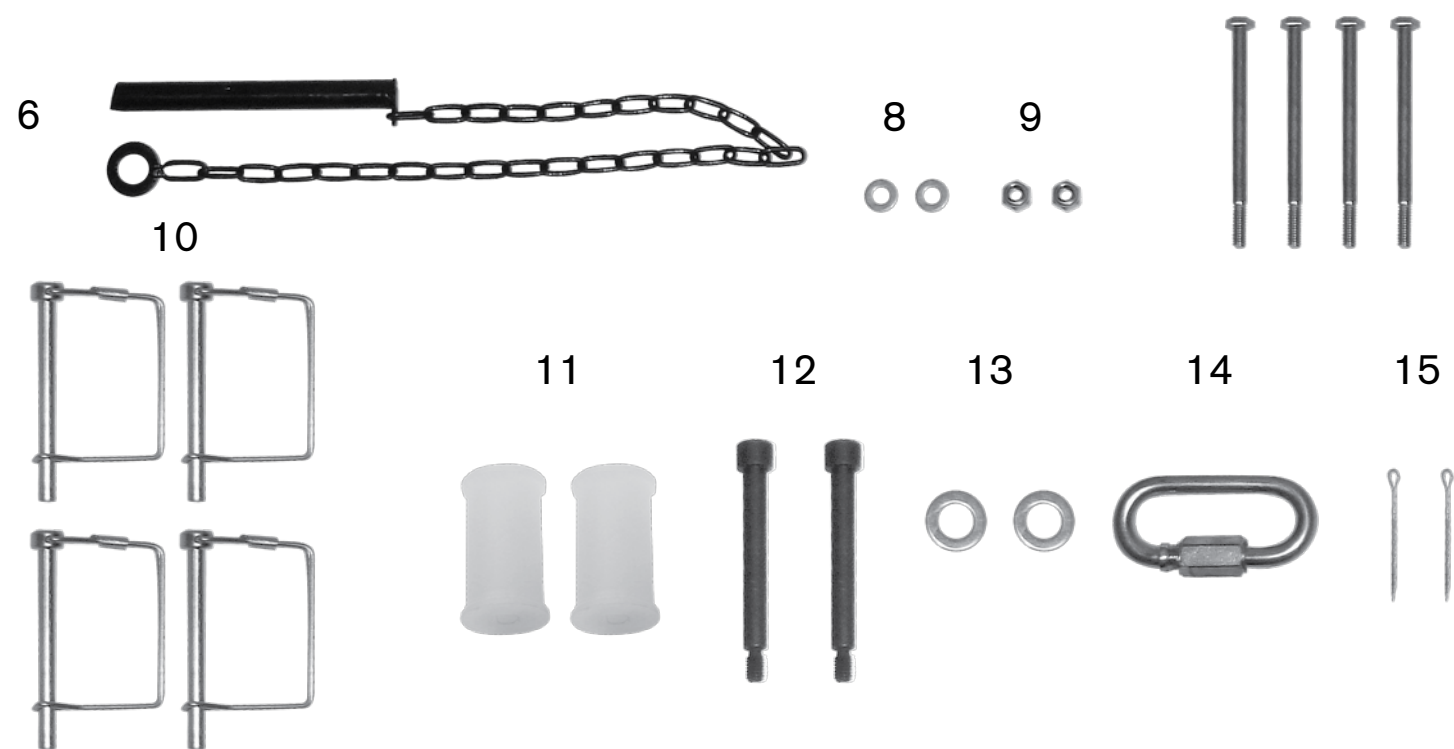

# PARTS

Item #	Quantity	Description
A	1	base
B	1	tower
C	1	winch
D	1	jack stand
E	2	jack stand inserts
F	1	T-Bar
G	2	wheel pads
H	2	wheels

## TOOLS NEEDED

- 8mm hex key
- (2) 10mm wrenches
- 13mm wrench
- 14mm wrench
- 17mm wrench
- 18mm wrench

## MOJACK™ OPERATING INSTRUCTIONS

Always ensure that your **MoJack** is on a level, solid surface.

1. Lower wheel pads to the ground by cranking winch counter clockwise.
2. Adjust width of wheel pads to correspond with front tires of riding lawn mower. Make sure wheel pads are secured to T-Bar using spring pin.
3. Drive or push riding lawn mower onto wheel pads, turn off and leave in neutral with parking break off.
4. Crank winch handle clockwise raising riding lawn mower to desired working height.
5. Place safety pin in tower.
6. Raise safety stand inserts so they are just below the T-Bar, make sure to use spring pin to keep safety stand inserts in place.
7. Lower T-Bar by cranking winch handle counter clockwise so T-Bar sits firmly on safety stand.
8. Set parking brake and chock back wheels of riding lawn mower.
9. Now you are able to begin service on your riding lawn mower.

## INSTRUCTIONS FOR REMOVING YOUR RIDING LAWN MOWER FROM THE MOJACK

1. Remove chocks from back tires and put riding lawn mower in neutral.
2. Raise T-Bar 1/2" by cranking winch clockwise.
3. Lower safety jack inserts and then lower safety stand.
4. Remove safety pin.
5. Lower T-Bar to the ground by cranking winch counter clockwise.
6. Remove riding lawn mower from the **MoJack** by pushing or driving it off of the wheel pads.

## MOJACK SAFETY REMINDERS

- Follow all OPERATING INSTRUCTIONS.
- Make sure riding lawn mower is turned off when using your **MoJack**.
- Use **MoJack** on stable, solid, level ground.
- Never attempt to lift more than **MoJack's** demonstrated lifting capacity of 300 lbs. for MJ-60 and 400 lbs. for MJ-60 and MJ-72. Exceeding this lifting capacity is extremely dangerous and can cause serious injury or death.
- DO NOT put safety stands in place until the safety pin has been placed in the tower.
- DO NOT begin maintenance on riding lawn mower until: safety pin is in place; T-Bar is resting safely on jack stands; and lifting strap is snug.
- The **MoJack** is intended for use with riding lawn mowers and riding lawn tractors only and should never be used to service other types of machinery.

**\*Important:** If the tires of your machine are 10" in diameter or smaller call 1-877-466-5225 to receive a cross bar that will fit your wheel size.